

LUMBERJACK CAMPER TRAILERS

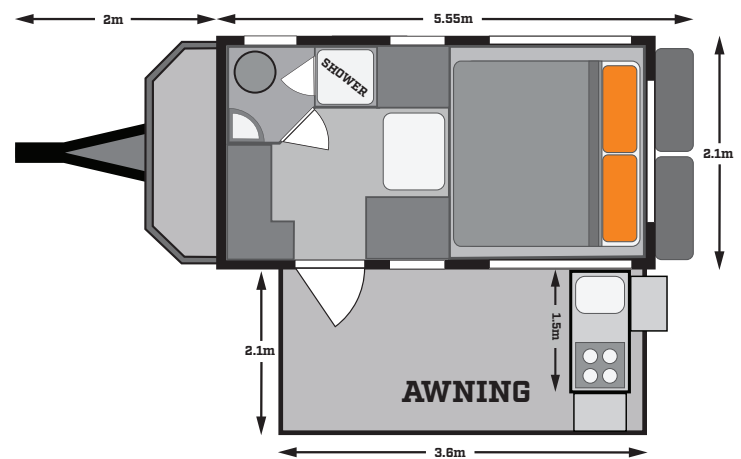

MT BAW BAW 16FT



SPECIFICATIONS

16 Foot Caravan Hybrid

Size closed [L] 7.55m [W] 2.1m [H] 2.75m [Closed] [H] 3.15m [Open]

Off Road Hybrid Caravan

Tare 2340kg* Ball Weight 180kg*

Drawbar Tube Size 150mm x 50mm x 4mm Hot Dip Galvanised

16" Mud Terrain Tyres with Alloy Rims Plus 2 Spares

Independent Coil Suspension & Dual Dobinson Shockers

12" Electric Brakes with Breakaway

Swing Up Jockey Wheel

Kitchen

Gas Connection to Stainless Steel Cooktop with Sink & Utility Drawers

2 x 80L Water Tanks Plus 80L Grey Water Tank

2 x 4.5kg Gas Bottle Holder & 2 x 20L Jerry Can Holder

Power Supply

Anderson Plug Connection for Car

2 x 12V AGM Batteries with Level Indicators

240V Connection with 4 x Double Power Points

Stereo Multimedia System (CD/DVD) with Dual Speakers & LCD Screen

Storage

7 x External Storage Compartments Including Large Front Toolbox

7 x Internal Storage Compartments Plus Under Bed & Seat Space

Body

Hot Water System For Both Internal & External Shower Outlets

Electric Awning, Inflatable Annex, Solar Panels & Air Conditioner Included

Gloss Interior Furnishings, PU Leather Seating With Removable Table

Secondary Screen Door & Windows With Block Out Blinds & Flyscreen

Multiple Internal & External LED Lights

Queen Sized Bed

*Accurate At Time Of Print.

Ph: 1300 30 40 45

lumberjackcampertrailers.com.au