



EILDON

FORWARD FOLDING HARD FLOOR WITH MOTORISED SETUP



The perfect family camper trailer with dining suite and stainless kitchen.

The Eildon is a camper fit for families with a spacious yet functional interior.

It features a Queen size main bed, full sized single bunk at the rear as well as a lounge space which can convert to another bed.

Mealtime is made easy with the exterior kitchen slide which houses the full 4 burner cooker & sink.

The unique high wall design of the cabin enables a higher tent roof to give amazing airflow during those hot months.



Lounge Which Converts to Another Sleeping Space



Spacious Cabin Tent with Extra High Roof for Airflow

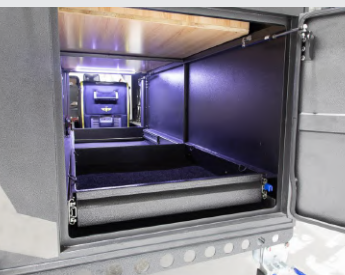

Large Dedicated Fridge Storage Space in Front Toolbox

	Approx. 2400kg
	Approx. 1860kg
	2 x 12v Deep Cycle
	Approx. 200kg
	2 x 9kg
	2 x 20L
	LED strips
	Yes
	12"
	1 x 120L 1 x 65L
	L x W x H 98 x 61 x 64.5
	King/Queen & Single Bunk
	Alloy

Forward Fold Trailer



SPECIFICATIONS

Size closed [L] 5.4m [W] 2.1m [H] 1.9m

● Standard ○ Optional Upgrade

TRAILER

Tare 1860kg* Ball Weight 200kg*	●
Drawbar Tube Size 100mm x 50mm x 4mm	●
Hot Dip Galvanised	●
16" Mud Terrain Tyres	●
Alloy Tyre Rims	●
2 Spare Tyres Included	●
Independent Coil Suspension	●
Dual Shockers	●
12" Electric Brakes	●
Al-ko Jockey Wheel	●

KITCHEN

Stainless Steel 4 Burner Cooktop with Lighting, Sink, Cutlery & Utility Drawer	●
120L & 65L Stainless Steel Water Tanks	●
Stainless Steel Tap	●
Hot & Cold Tap Function (External HWU Required)	●
Hot Water Unit (HWU)	●

POWER

Anderson Plug Connection for Car	●
2x 12V Deep Cycle Battery	●
Control Panel with Voltmeter & Water Gauge	●
Multiple 12v Sockets with Dedicated Fridge Socket	●

STORAGE

5 x External Storage Compartments including dedicated pole space	●
3 x Internal Storage Compartments	●
2 x 9kg Gas Bottle Holders	●
2 x 20L Jerry Can Holders	●
Dedicated Fridge Slide with Power Supply	●

TENT

14oz Waterproof Tent with Awning, Walls, Tropical Roof & Annex Flooring included	●
Quick Release Alloy Poles	●
Midge Proof Mesh Used On All Windows & Door	●
Internal & External Window Canvas in Main Cabin Area	●
Guide Ropes & Pegs Kit Included	●
Gas Strut Assisted Setup	●

EXTERIOR GENERAL

Powder Coated Steel Front Toolbox	●
Sleek Black Hammertone Finish	●
Lumberjack Style Mudflaps	●
Trailer Plug to suit vehicle	●
Steel Frame Stone Guard with Mesh Webbing	●

INTERIOR GENERAL

Stereo System (CD, MP3, BT, SD & USB)	●
Multiple Internal LED Light Strips plus step light & External LED Light	●
Queen Sized Main Bed	●
Single Sized Bunk Bed	●
Convertible Seating to a Double Bed	●
PU Leather Seating	●
Collapsible Table Included	●
Wood Printed Vinyl Flooring	●
Dual Interior Speakers	●
Built in Window with Block out & Flyscreen Panels	●

SAFETY

Fire Extinguisher Included	●
High strength recovery points at rear	●
ADR Approved safety chains at coupling	●
Victorian Standard Breakaway included	●

OPTIONAL UPGRADES

16" Good Year All Terrain Tyres	○
Dobinson Branded Shockers	○
Gas Connection to the Cooker	○
Extra Gas Bayonette Fitting	○
2 x 12v AGM Batteries	○
240v Connection	○
Installed Diesel Heater	○

CAMPING ACCESSORIES

72L Dual Zone Fridge Freezer	○
Double Ensuite Shower Tent	○
Portable Camping Toilet	○
160w Portable Solar Panels	○
2000w Camping Heater	○
120L Cooler Box	○

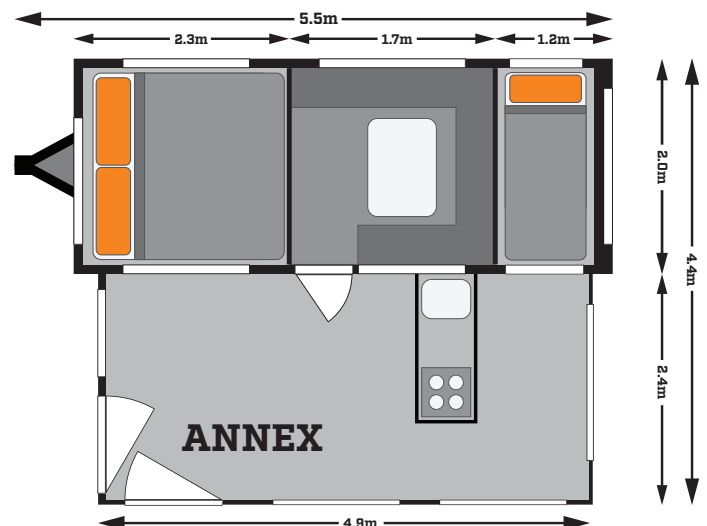

* Data accurate at time of print, check online for most current information.