



# JOHANNA *Ultra Light*

FORWARD FOLDING HARD FLOOR



Two Spare Tyres included On Rear Drop Down Support



Full 4 Burner Cooker & Sink with Hot & Cold Facility



Multiple Interior Storage Cupboards & Drawers



The camper for everyone, from retirees to small families

The Johanna has been given a major update & now comes with a fresh new look.

The new StyroMAX Fibreglass body makes it lighter than ever before but still tough enough for your outback adventures.

We have increased the water storage space as well as adding new hot & cold water tap facilities. While we have made great updates we have also kept the great interior storage & full exterior kitchen you love.



ATM

Approx. 2050kg



Tare

Approx. 1520kg



Battery

2 x 12v Deep Cycle



Ball Weight

Approx. 180kg



Gas Bottle Holders

2 x 9kg



Jerry can Holders

2 x 20L



Lighting

LED strips



Stereo

Yes



Electric Brakes

12"



Water Tanks

1 x 120L  
1 x 40L



Fridge Slide (cm)

L x W x H  
98 x 54 x 56.5



Mattress Size

King



Poles

Alloy

Ph: 1300 30 40 45

[lumberjackcampertrailers.com.au](http://lumberjackcampertrailers.com.au)

# JOHANNA *Ultra Light*



## Forward Fold Trailer



### SPECIFICATIONS

Size closed [L] 5.7m [W] 2.1m [H] 1.6m

● Standard ○ Optional Upgrades

#### TRAILER

|                                      |   |
|--------------------------------------|---|
| Tare 1520kg* Ball Weight 180kg*      | ● |
| Drawbar Tube Size 100mm x 50mm x 4mm | ● |
| Hot Dip Galvanised                   | ● |
| 16" Mud Terrain Tyres                | ● |
| Alloy Tyre Rims                      | ● |
| 2 Spare Tyres                        | ● |
| Independent Coil Suspension          | ● |
| Dual Shockers                        | ● |
| 12" Electric Brakes                  | ● |
| Al-ko Jockey Wheel                   | ● |

#### KITCHEN

|  |   |
|--|---|
| Stainless Steel 4 Burner Cooktop with Lighting, Sink, Cutlery & Utility Drawer | ● |
| 120L & 40L Plastic Water Tanks with Bash Plate                                 | ● |
| Stainless Steel Tap  | ● |
| Hot & Cold Tap Function (External HWU Required)                                | ● |
| Hot Water Unit (HWU)   | ● |

#### POWER

|   |   |
|---|---|
| Anderson Plug Connection for Car                  | ● |
| 2 x 12V Deep Cycle Battery                        | ● |
| Control Panel with Voltmeter & Water Gauge        | ● |
| Multiple 12V Sockets with Dedicated Fridge Socket | ● |

#### STORAGE

|  |   |
|--|---|
| 7 x External Storage Compartments including dedicated pole space | ● |
| 5 x Internal Storage Compartments Plus Under Seat Space          | ● |
| 2 x 9kg Gas Bottle Holders                                       | ● |
| 2 x 20L Jerry Can Holders  | ● |
| Dedicated Fridge Slide with Power Supply                         | ● |

#### TENT

|  |   |
|--|---|
| 14oz Waterproof Tent with Awning, Walls, Tropical Roof & Annex Flooring included | ● |
| Quick Release Alloy Poles  | ● |
| Midge Proof Mesh Used On All Windows & Door                                      | ● |
| Internal & External Window Canvas in Main Cabin Area                             | ● |
| Guide Ropes & Pegs Kit Included  | ● |
| Gas Strut Assisted Setup   | ● |

#### EXTERIOR GENERAL

|   |   |
|---|---|
| StyroMAX Fibreglass body                  | ● |
| Lumberjack Style Mudflaps                 | ● |
| Trailer Plug to suit vehicle              | ● |
| Steel Frame Stone Guard with Mesh Webbing | ● |

#### INTERIOR GENERAL

|   |   |
|---|---|
| Stereo System (CD, MP3, BT, SD & USB)                           | ● |
| Internal LED Light Strips plus step light & External LED Lights | ● |
| King Sized Main Bed   | ● |
| Convertible Seating to a Double Bed                             | ● |
| PU Leather Seating  | ● |
| Wind Down Table Included  | ● |
| Wood Printed Vinyl Flooring                                     | ● |
| Dual Interior Speakers  | ● |
| Canvas Privacy Screen to Main Bed                               | ● |

#### SAFETY

|                                       |   |
|---------------------------------------|---|
| Fire Extinguisher Included            | ● |
| High strength recovery points at rear | ● |
| ADR Approved safety chains & coupling | ● |

#### OPTIONAL UPGRADES

|                                 |   |
|---------------------------------|---|
| 16" Good Year All Terrain Tyres | ○ |
| Dobinson Branded Shockers       | ○ |
| Gas Connection to the Cooker    | ○ |
| Extra Gas Bayonet Fitting       | ○ |
| 2 x 12v AGM Batteries           | ○ |
| 240v Connection                 | ○ |
| Installed Diesel Heater         | ○ |

#### CAMPING ACCESSORIES

|                              |   |
|------------------------------|---|
| 95L Dual Zone Fridge Freezer | ○ |
| Double Ensuite Shower Tent   | ○ |
| Portable Camping Toilet      | ○ |
| 160w Portable Solar Panels   | ○ |
| 2000w Camping Heater         | ○ |
| 120L Cooler Box              | ○ |

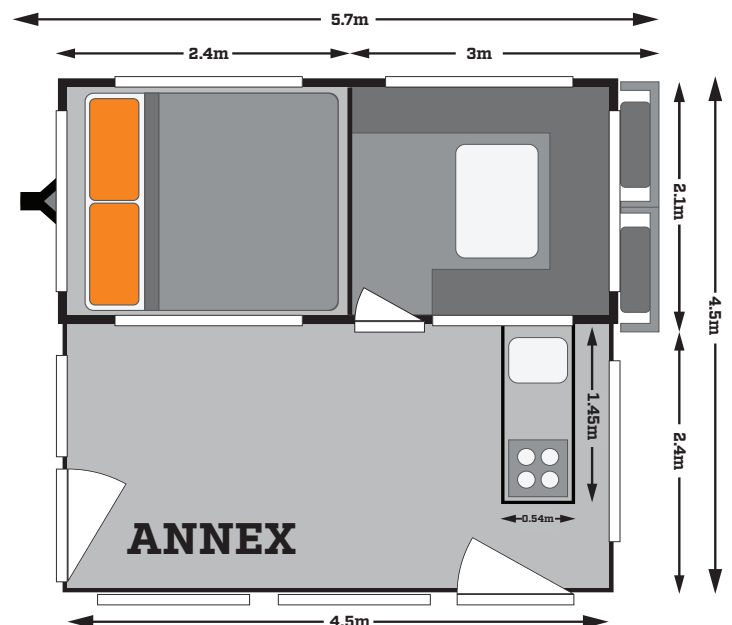

\* Data accurate at time of print, check online for most current information.