

EVOLUTION SERIES MACEDON

19FT HARD ROOF TOY HAULER



CAPACITY: 2 ADULTS
2 CHILDREN

THE NEW EVOLUTION OF LUMBERJACK HAS ARRIVED. . .

**A TOY HAULER FOR FAMILIES WHO LOVE
GETTING OFF-ROAD & HITTIN' THE MOUNTAIN TRAILS!**

Take your camping trips to the next level with this family size toy hauler hybrid fitted with all the luxuries you need.

It features a rear drop down access ramp which can double as a sun deck area, fold away single beds, interior ensuite room with toilet & shower as well as much more.

The 9 floor mounted tie down points mean you have the space you need for your bikes to come along on your adventures.



Approx.
3500kg



Approx.
2590kg



Ball Weight

Approx.
280kg



Battery

2 x 150Ah
Lithium



Charger System

REDARC
Power System
& Inverter



Gas & Jerry
Holders

2 x 9kg Gas
2 x 20L Jerry



Power

240v Connection
Included



Heating
& Cooling

Dometic Dual
System Inc.



Water Tanks

2 x 95L Clean
1 x 125L Grey



Capacity

2 Adults
2 Children

Ph: 1300 30 40 45

Lumberjackcampertrailers.com.au



EVOLUTION SERIES MACEDON

19FT HARD ROOF TOY HAULER



SPECIFICATIONS

Size closed [L] 8.1m [W] 2.4m [H] 3.1m (inc. AC)



● Standard ○ Optional Upgrades

TRAILER

Tare 2590kg* Ball Weight 280kg*	●
Drawbar Tube Size 150mm x 50mm x 4mm	●
Hot Dip Galvanised	●
16" Mud Terrain Tyres with 1 Spare Included	●
Alloy Tyre Rims	●
Heavy Duty removable Jockey Wheel	●
Do35 Hitch with Receiver Coupling	●
12" Electric Brakes & Manual Handbrake	●

SUSPENSION

Dual Axle Independent Suspension System	●
Heavy Duty Coil Springs & Shock Absorbers	●

STORAGE

1 x Large Front Toolbox	●
Dual dedicated Fridge Slides with Power Supply	●
19+ Interior Storage Cupboards & Drawers	●
4 x External Storage Hatches & Drawers	●
2 x 9kg Gas Bottle Holders	●
2 x 20L Jerry Can Holders	●

KITCHEN & BATHROOM

Interior & Exterior Thetford 3 Burner Cooktops with Lighting & gas plumbing connections.	●
2 x 95L Fresh Water Tanks	●
125L Grey Water Tank	●
700w Microwave	●
Thetford 152L Fridge	●
Thetford Cassette Toilet	●
Installed On Board Truma Hot Water Unit	●
External Shower Outlet	●
Interior Ensuite shower with Movable Rose head, Roof Ventilation, LED Lighting & Full size Mirror on entry door	●

EXTERIOR GENERAL

Fibreglass Body with Aluminum Internal Frame	●
Black Raptorcoat Lower body Wrap	●
Entry Door with Separate Screen Door	●
5m x 2.3m Electric Sunshade Awning with LED Lighting	●
Electric Operating Rear Loading Ramp/ Sundeck with Safety Railing, Roof with lighting & 9 x Tie down points	●
Choice of body colours from Crisp white with Orange decals or Charcoal Grey with Lime decals	●

SAFETY

Fire Extinguisher Included	●
ADR Approved safety chains & coupling	●
Dual Internal Smoke Alarms	●
Reversing Camera Included	●

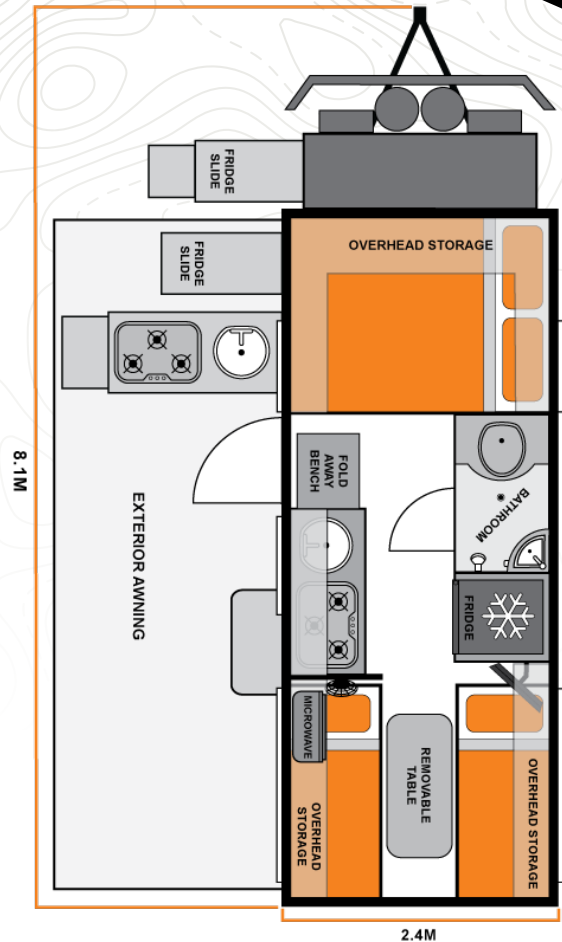

INTERIOR GENERAL

Multimedia Touch screen Stereo System & 24" Smart TV	●
Dometic Dual System Heating & Cooling Air Conditioner	●
Internal & External LED Lighting throughout	●
Queen Size Main Bed	●
2 x Fold Away Single Beds	●
Dual Interior & Exterior Speakers	●
Windows with Block out & Fly screen Panels	●
Wood Printed Vinyl Flooring	●
Black cabinetry finishings with soft closing drawers	●
Built In Sky Light Hatch with LED Lighting	●

POWER

REDARC Battery Management System with Solar Reg, Charging, & Bluetooth Controls	●
Anderson Plug Car Connections	●
2 x 150ah Lithium Batteries	●
Dual 150w Roof Mounted Solar Panels	●
12v / 240v Inverter System	●
240V Connection with Multiple GPO Points	●
Multiple 12V Sockets with Dedicated Fridge Sockets	●

OPTIONAL UPGRADES

Additional Gas Bayonet Fitting	○
Additional 240V Outlet Point	○

CAMPING ACCESSORIES

65L Dual Zone Fridge Freezer	○
2KVA Generator	○
Double Size Sleeping Bag	○

* Data accurate at time of print, please visit website product listing for more unit specifications & most current information.